

WRQK lugs and connectors

Ref: RQK	16	25	35	50	70	95	120	150	185	240	300	
	20	25	30	38	38	45	50	60	60	70	70	80
Stud Hole (mm)	6	6	8	10	10	10	12	16	16	16	16	16

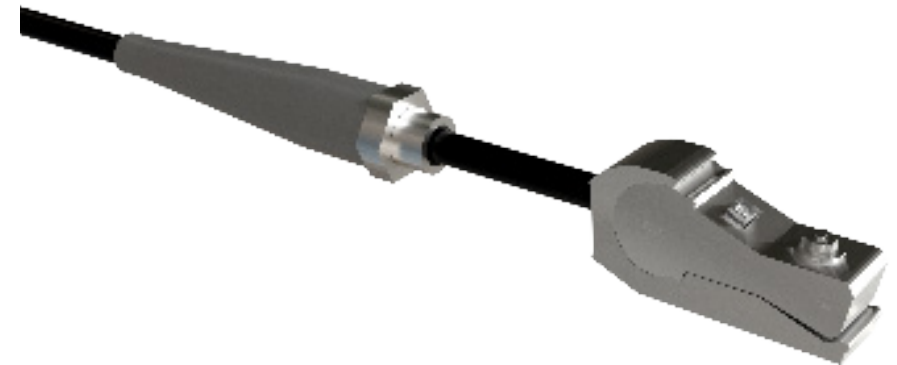

The Directions for Installation are as follows:

Remove 'L' mm of conductor sleeving. (See Table)

Abraid the exposed conductor to remove the mineral insulant.

Assemble the lug, so that the XX marking is facing outwards.

Abraid the exposed conductor to remove the mineral insulant.

Fully insert the conductor into the lug.

Bolt the lug to the apparatus and tighten with a spanner. When the lug is fully closed tighten the nut an additional 1/4 to 1/2 a turn.

